

# EPS Bulk Insulation Boards

Fire-retardant FRCel EPS boards & cut-to-order sheets · grades EPS 12–30

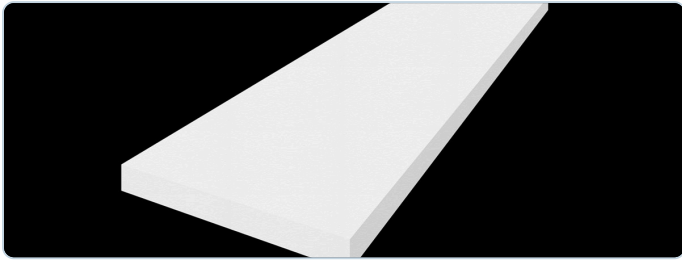

## Overview

Technopol's EPS bulk insulation range is fire-retardant (**FRCel**) expanded polystyrene supplied as flat boards and cut-to-order sheets in five published grades, **EPS 12 to EPS 30**. The closed-cell, non-hygroscopic material insulates down to  $\lambda$  **0.033 W/m·K**, and the required R-value is reached simply by thickness ( $R = \text{thickness} / \lambda$ ) — supporting SANS 10400-XA energy compliance. The same boards serve as over-ceiling insulation, cavity-wall boards, under-floor / under-screed insulation and backing boards for rendered external wall insulation (ETICS/EIFS). Sheets are hot-wire cut to any thickness for an exact fit.

## Applications

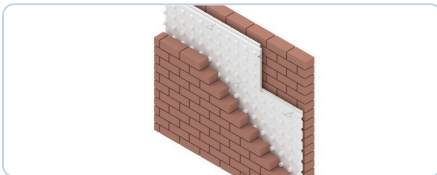

Cavity-wall insulation boards



ETICS / EIFS backing boards

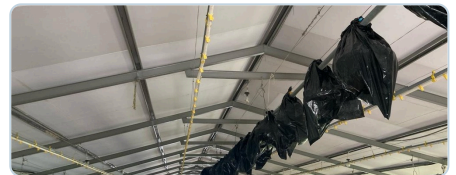

Ceiling & roof insulation sheets

Also: under-floor / under-screed insulation · the moulded PolyKey and LiteCel Cavity & Drainage cavity-wall lines · cut-to-order sheets and shapes for packaging, display and construction.

## Benefits

- Thermal conductivity down to 0.033 W/m·K — closed-cell, non-hygroscopic
- Five published grades (EPS 12–30): match density to thermal target and load
- Fire-retardant FRCel — Class B-s1,d0 reaction-to-fire (SANS 53501-1)
- Cut to order — any thickness, hot-wire precision, minimal site waste
- Very light: fast handling and installation, no special plant
- Rigid boards hold their R-value — rot-proof and 100% recyclable

## Specifications

Grades	EPS 12 · 15 · 20 · 24 · 30 (nominal density 12–30 kg/m <sup>3</sup> )
Thermal conductivity ( $\lambda$ )	EPS 30: 0.033 · EPS 24: 0.034 · EPS 20: 0.035 · EPS 15: 0.038 · EPS 12: 0.040–0.045 W/m·K
Compressive stress @10% strain	60–200 kPa min (grade-dependent)
Safe working load @1% strain	15–100 kPa — the design limit for sustained loads
R-value	$R = \text{thickness} / \lambda$ ; e.g. 100 mm FRCel @ 20 kg/m <sup>3</sup> $\approx R 2.86 \text{ m}^2\text{K/W}$
Sheet supply	Custom-cut to order, up to 6000 × 1240 mm from 10 mm thick (confirm current cutting envelope with Technopol)
Service temperature	80 °C long-term / 100 °C short-term · dimensional stability $\leq 1.0\%$
Material	Closed-cell, non-hygroscopic, 100% recyclable; not UV-stabilised — store under cover

Values per Technopol's published grade tables; the laboratory property sheet lists EPS 15 at  $\lambda$  0.040 W/m·K — confirm grade-specific design values with Technopol.

**Compliance.** Fire-retardant **FRCel** EPS is classified **Class B-s1,d0** to SANS 53501-1 (reaction-to-fire, Ignis report IT 23-08-00009, tested on FRCel 20DV) — lowest smoke class, no flaming droplets. This is a reaction-to-fire classification, **not** a fire-resistance (minutes) rating; EPS remains a combustible material — keep open flame away during storage and installation. Grades and thicknesses support **SANS 10400-XA** deemed-to-satisfy R-value compliance. Bulk insulation boards are not an Agrément-certified product line.

Request grades, sheet sizes & a project quote — [info@technopol.co.za](mailto:info@technopol.co.za) · +27 11 363 2780 · [technopol.co.za](http://technopol.co.za)